

# ASTM UNION ELBOW

- Fabrication Standards: American Standard Class 150
- Material: ASTM A197/A197M
- Dimensions: ASME B16.3, B16.14
- Union Dimensions: B16.39
- Threads: ASME B1.20.1
- Size Available: 1/8" - 8"

96A

Union Elbow

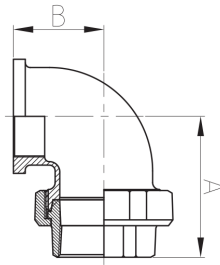

Size	Inch	1/2	3/4	1	1 1/4	1 1/2	2
	mm	15	20	25	32	40	50
Dim. (mm)	A	57	59	72	82	88	99
	B	27	29	34	43	47	56
Size	Inch						
	mm						
Dim. (mm)	A						
	B						